

SUBMITTAL SHEET

LCH-7H

Heat Recovery Ventilator

500 CFM (236 L/s) to 750 CFM (354 L/s)

Item No. 463301



FEATURES

- Heat recovery cross-flow core
- Fans with backward curved blades
- Reversible application
- Reversible electrical control panel
- Push-pull configuration
- 100% variable speed
- MERV3 rated filters
- Full length drain pan

OPTIONS

- 463306 GTDMK14 Recirculation 24V damper module kit
- 463308 GTPDK14 O/A 24V motorized prevention damper kit



GTDMK14



GTPDK14

CABINET

20 gauge corrosion resistance prepainted G90 galvanized steel. insulated with 1 in. (25 mm) fiberglass with FSK facing.

MOTORS

Two (2) high performance, variable speed, maintenance-free Ebm-Papst™ backward curved blades motorized impellers with permanently lubricated sealed ball bearings and (TOP) thermal overload protected.

HEAT RECOVERY CORE

The heat recovery cores are fixed plate cross-flow heat exchanger using 1100 alloy aluminum and capable of transferring sensible heat between air streams. Engineered with a turbulence inducing geometry in order to maximize heat transfer. The plates are hemmed to avoid cross-contamination of airstreams.

FILTERS (MERV3)

The exhaust and fresh air streams are protected by MERV3 washable filters constructed to meet UL 900.

ELECTRONIC BALANCING SYSTEM (DUOTROL)

- The system is balanced by adjusting each motor independently
- No balancing dampers required
- Connection terminals for optional wall controls
- Quiet and energy efficient

DEFROST SEQUENCE

The defrost sequence is electronically controlled to measure the incoming outdoor air temperature, the sequence is activated at -5°C (23°F) and colder. This system eliminates that the heat recovery or energy recovery core doesn't build with ice or freezes.

Standard defrost type: (Evacuation) The supply fans shuts down, the exhaust fan speed increases pending the measured outside temperature.

Optional defrost type: (Recirculation*) A motorized damper closes the fresh air from outside port, the exhaust fan shuts down, the supply fan increases speed and will draw warm ambient air from the 5th port located upper left side.

*Requires GTDMK14 damper module kit.

MAINTENANCE

Cores, filters and drain pan can be accessed easily from both sides of the HRV from hinged access panels. Cores conveniently slide out with only 15" (380 mm) clearance. Motors can be accessed from both sides of the HRV from easy access panels. Motors are easily accessible by removing the access panel and sliding the motor assemblies out of the HRV. A quick disconnect allows for fast inspection of motors.

MOUNTING

Unit may be suspended by using threaded rod, or saddle type installation on a platform. (not supplied). Unit shall be adaptable for easy service of electrical components.

WARRANTY

Greentek HRVs have a warranty that is limited to 2 years on all components and limited 15 years for the HRV core, from the date of purchase, including parts replaced during this time period. If there is no proof of purchase available, the date associated with the serial number will be used for the beginning of the warranty period

AIRFLOW

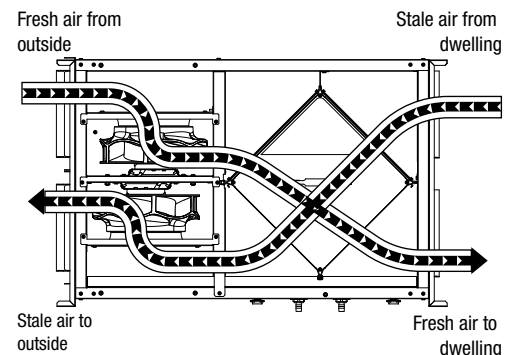

Greentek
50 Kanalfakt Way,
Boucouché, NB Canada E4S 3M5

Toll free: 1 888 724-5211
Fax: 1 (866) 426-7430

Visit us at: www.greentek.ca

E400070/ May 2022



Greentek reserves the right to modify a product, without prior notice, whether in design, colour or specifications, in order to offer at all times a quality product that is highly competitive. Please consult your national and local building codes to find out whether the installation of electrical products requires the services of a certified technician or electrician. Greentek™ is a registered Trademark used under license by Systemair Inc. All rights reserved.

SUBMITTAL SHEET LCH-7H

SPECIFICATIONS LCH-7H

Dimensions	36.57" x 36.2" x 22" (929 mm x 920 mm x 559 mm)
Duct Connections	Four (4) 8" x 14" (203mm x 355mm)
Airflow Rates	500 CFM (236 L/s) to 750 CFM (354 L/s)
Motor	Two (2) factory balanced fans with backward curved blades
Voltage	120 VAC @ 60 Hz / 1 Phase
Amperage	5.58A / 670 Watts
Type of Heat Exchanger	Two (2) Cross-flow (Enthalpic Polymer Membrane)
Exchange Surface	>342 in ² (0.22m ²)
Standard Defrost Type	Evacuation
Filters	Four (4) MERV3 washable filters
Drain Connection	Two (2) 1/2" (12.7 mm)
Actual Weight	169 lbs (77 Kg)
Shipping Weight	179 lbs (81 Kg)
Shipping Dimensions	38" x 38" x 27" (965mm x 965mm x 686mm)
Certification	cCSAUS, CSA 22.2 N ^o .113 Complies with UL 1812

OPTIONAL WALL CONTROLS

Vectra Series	EHC 1.5 and EHC 1.0
RD Series	RD-1, RD-2, RD-3P, RD-4P, RD-3D*, RD-4D* * Recirculation
Timers	T3 (20, 40, 60 minutes)

WALL CONTROL DIMENSIONS

Vectra Series

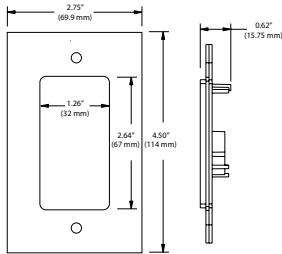

RD Series

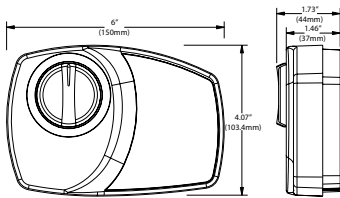

T3 Timer

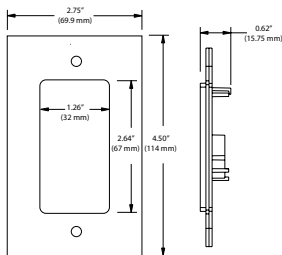

DIMENSIONS DATA

Side View

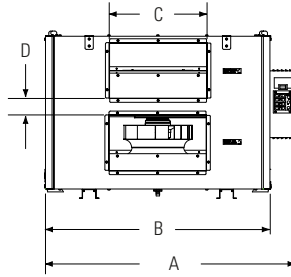

Front View

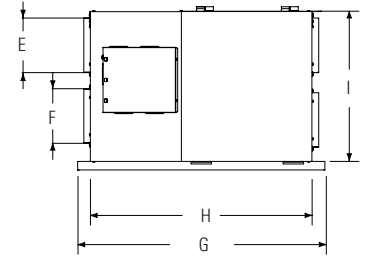

A	B	C	D	E	F	G	H	I
in (mm)	in (mm)	in (mm)	in (mm)	in (mm)	in (mm)	in (mm)	in (mm)	in (mm)
36.57 (929)	32.33 (821.2)	14 (355)	2.5 (63)	8 (203)	8 (203)	36.2 (920)	32.5 (826)	22 (559)

VENTILATION PERFORMANCE

in. wg. (Pa)	0.2 (50)	0.4 (100)	0.6 (150)	0.8 (200)	1.0 (250)	1.4 (350)	1.8 (450)	2.2 (550)
	cfm (L/s)	cfm (L/s)	cfm (L/s)	cfm (L/s)	cfm (L/s)	cfm (L/s)	cfm (L/s)	cfm (L/s)
Supply High	753 (355)	723 (341)	689 (325)	653 (308)	613 (289)	522 (246)	418 (197)	301 (142)
Supply Med	552 (260)	487 (230)	424 (200)	362 (171)	302 (143)	187 (88)	118 (56)	-
Supply Low	432 (204)	352 (166)	274 (129)	196 (93)	120 (57)	-	-	-

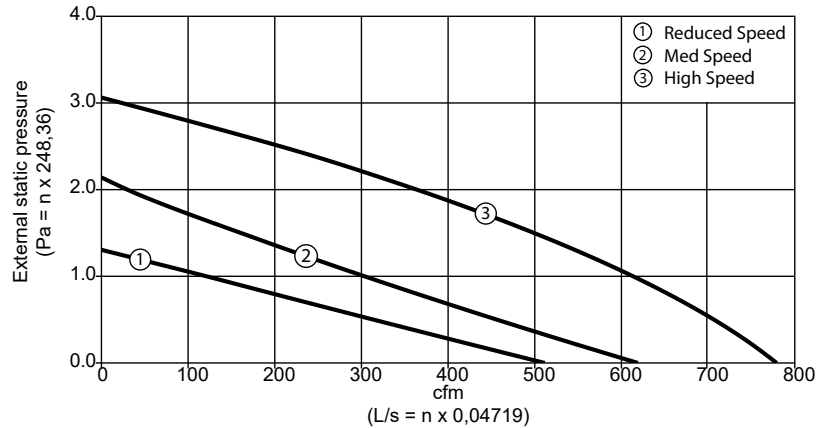

ENERGY PERFORMANCE CORE*

	Net Air Flow		Net Effectiveness	
	L/s	CFM	Sensible	Total
HEATING	326	690	57	37
	244	518	61	40
COOLING	326	690	47	18
	244	518	49	19

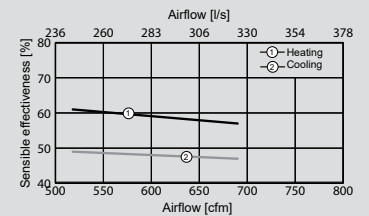

*Actual performance may vary pending conditions

SUBMITTAL SHEET LCH-7H

Job Name:		
Job Location:		
Job Reference Number:		
Unit Reference Number:		
Engineer:		
Distributor:		
Contractor:		
For Reference:	For Approval:	For Construction:
Submitted by:	Date:	
Address:		
Tel:	Fax:	Email:
Notes:		