

# ENGINEERING DATA

## SS 3.80 HRV model

Heat Recovery Ventilator

30 CFM (14 L/s) to 100 CFM (47 L/s)

Item No. 463014 (SS 3.80 Greentek)



### FEATURES

- 3 operating modes (Intermittent, Continuous & High)
- 100% variable speed
- ISF™ 5" (127 mm) oval collar system
- Proportional defrost sequence
- Single person mounting system via wall bracket
- Permanent lubrication PSC motors

### APPLICABLE REQUIREMENTS

- HVI Certified
- CSA C439 Standard - Packaged Heat/Energy Recovery Ventilators (HRV/ERV)
- CSA Standard CSA 22.2 N°113 - Fans and ventilators
- UL Standard 1812. Ducted Heat/Energy Recovery Ventilators (HRV/ERV)

### OPTIONAL ACCESSORIES

- MERV 8 Inline 6" (152.5 mm) filter box
- Matrix 2 in 1 high performance concentric ventilation hood
- R-2 Style high performance supply & exhaust ventilation hoods

### CABINET

- 22 gauge galvanized pre-painted steel corrosion resistant
- Cabinet liner: Molded Expanded Polystyrene (EPS)  
Rated UL94 HF-1

### ELECTRONIC COMPONENTS

- Electrical Input Voltage: 120 VAC/60Hz / 1-Phase.
- Electrical Input Current: 0.85 Amps Max
- Circuit output voltage: 5VDC nominal
- Integrated auxiliary furnace interlock relay
- RoHs compliant

### MOTORS

- Two permanent sealed, lubricated variable speed PSC Motors. (Maintenance free)
- Maximum RPM 3135 / Horsepower; 1/11 HP. Class F, thermally protected
- CSA 22.2 #113-10, clause 8.3.5  
– Backup protection – totally enclosed motor

### POLYPROPYLENE HRV CORE

- Dimensions 10" x 10" x 9" depth (254 mm x 254 mm x 228.6 mm)
- Corrugated cross-flow polypropylene layers, rated UL94 HB & HF-1
- Cross-flow that transfers sensible heat
- Endure harsh temperatures; effective in cold climates
- Water washable

### DUOTROL™ BALANCING SYSTEM

- The system is balanced by adjusting each motor independently
- No balancing dampers required
- Connection terminals for optional wall controls
- Quiet and energy efficient

### DEFROST

- Advanced Proportional supply fan shut down defrost sequence
- Defrost type: Evacuation  
Activated automatically at -5°C (23°F)

### DUCT CONNECTIONS

- Insert Slide & Fix (ISF™), removable collars system
- Four (4) 5" (127 mm) oval double collar
- Intergrated balancing pressure taps

### MOUNTING

- Wall mount bracket included

### FILTERS

- Two (2) Fiberbond washable - 9" x 10" x ½" (228.6 mm x 254 mm x 15.9 mm)
- UL Class 2

### WARRANTY

- 5 year limited warranty on motors
- 5 year limited warranty on parts
- Lifetime limited warranty on Heat Recovery Core

### AIRFLOW

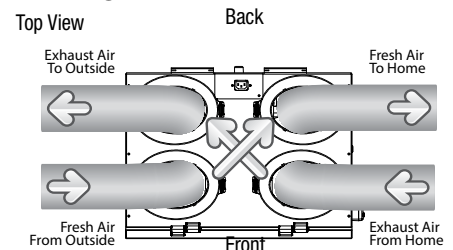

Greentek  
50 Kanalfakt Way,  
Bouctouche, NB Canada E4S 3M5

Toll free: 1 888 724-5211  
Fax: 1 (866) 426-7430

Visit us at: [www.greentek.ca](http://www.greentek.ca)

463688 / APRIL2022



Greentek reserves the right to modify a product, without prior notice, whether in design, colour or specifications, in order to offer at all times a quality product that is highly competitive. Please consult your national and local building codes to find out whether the installation of electrical products requires the services of a certified technician or electrician. Greentek™ is a registered Trademark used under license by Systemair Inc. All rights reserved.

# ENGINEERING DATA SS 3.80 HRV

## SPECIFICATIONS SS 3.80 HRV

<b>Dimensions</b>	22" x 19 <sup>15</sup> / <sub>16</sub> " x 14 <sup>19</sup> / <sub>32</sub> " (558.8 mm x 502.9 mm x 370.8 mm)
<b>Duct Connections</b>	Four (4) 5" (127 mm) oval ISF double collar system
<b>Airflow Rates</b>	30 CFM (14 L/s) to 100 CFM (47 L/s)
<b>Motor</b>	Two (2) PSC variable speed backward curved
<b>Voltage</b>	120 VAC @ 60 Hz / 1 Phase
<b>Amperage</b>	0.85 A / 66 watts
<b>Type of heat exchanger</b>	Cross-flow Polypropylene
<b>Exchange surface</b>	63.5 ft <sup>2</sup> (5.9 m <sup>2</sup> )
<b>Defrost type</b>	Evacuation
<b>Filters</b>	Two (2) Fiborbond washable
<b>Drain Connection</b>	½" (12.7 mm)
<b>DuoTrol</b>	Integrated Balancing System
<b>Actual Weight</b>	33.5 lbs (15.2 Kg)
<b>Shipping Weight</b>	41 lbs (18.6 Kg)
<b>Certification</b>	HVI, cCSAUS, CSA 22.2 N <sup>o</sup> .113 Complies with UL 1812

## OPTIONAL WALL CONTROLS

<b>Digital</b>	EHC1.0TC and EHC1.5DC
<b>Mechanical</b>	RD-1, RD-2, RD-3P and RD-4P
<b>Timers</b>	T3 (20, 40, 60 minutes)

## WALL CONTROL DIMENSIONS

### EHC1.0 & EHC1.5

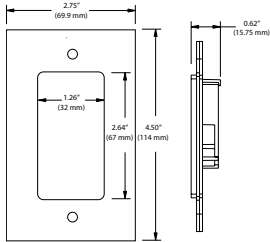

### Mechanical

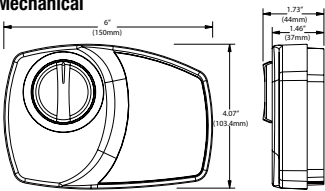

### T3 Timer

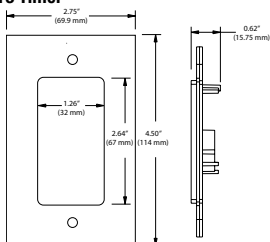

## DIMENSIONS DATA

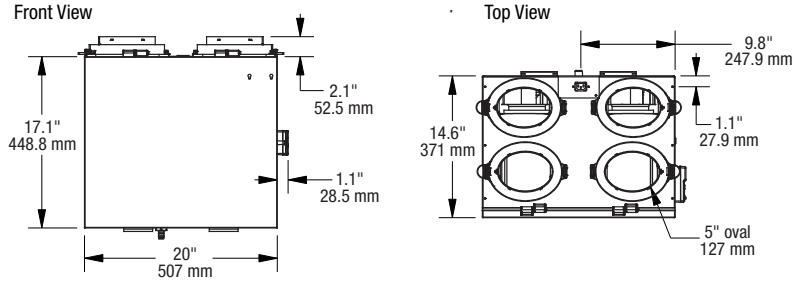

## MINIMUM CLEARANCE DATA

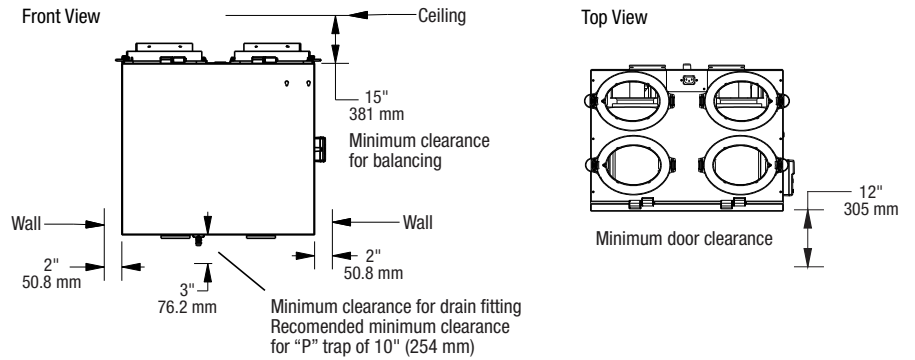

## VENTILATION PERFORMANCE

External Static Pressure	Net Supply Air Flow		Gross Air Flow Supply		Gross Air Flow Exhaust		
	Pa	in. wg	L/s	CFM	L/s	CFM	L/s
25	0.1	46	97	46	97	47	100
50	0.2	42	89	42	89	43	91
75	0.3	38	81	38	81	41	87
100	0.4	34	75	35	74	38	81
125	0.5	31	66	31	66	34	72
150	0.6	26	55	26	55	29	61
175	0.7	21	44	22	47	20	42

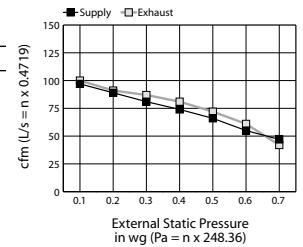

## ENERGY PERFORMANCE

	Supply Temperature		Net Air Flow		Power Consumed		Sensible Recovery		Adjusted Sensible	
	°C	°F	L/s	CFM	Watts		Efficiency (SRE %)		Recovery Efficiency (ASRE %)	
<b>HEATING</b>	0	32	23	49	32		69		74	
	0	32	31	66	40		66		70	

Quoted by:	Date:
Project:	Remarks:
Quantity:	
Model:	
Site:	
Architect:	
Engineer:	
Contractor:	