

ENGINEERING DATA

LCH-12E

Energy Recovery Ventilator
1200 CFM (566 L/s)

Item No. 463305



FEATURES

- Push-pull configuration
- 4 Operating modes (Intermittent; Continuous; High)
- Dual service doors & reversible electrical box

APPLICABLE REQUIREMENTS

- Technical data was obtained from published results of test relating to AHRI 1060 Standards
- CSA Standard CSA 22.2 N^o.113-10 - Fans and ventilators
- UL Standard 1812 2nd Ed. Ducted heat/energy recovery ventilators (HRV/ERV)

OPTIONS

- 463309 GTPDK20 O/A motorized prevention damper kit



GTPDK20

CABINET

- 20 gauge galvanized pre-painted steel corrosion resistant

ELECTRONIC COMPONENTS

- Electrical Input Voltage: 120 VAC/60Hz / 1-Phase
- Electrical Input Current: 11.17 Amps Max
- Integrated auxiliary furnace interlock relay
- Intergrated 24V connection (18VA)
- RoHs compliant

MOTORS

- Four (4) factory balanced fans with backward curved blades.
- Motors come with permanently lubricated sealed ball bearings, maintenance free
- Thermal overload protection
- 115V, 60Hz, 2.92 Amps
- Maximum RPM 2750 / Horsepower; 0.42 HP

POLYMER MEMBRANE ERV CORE

- Dimensions (3) 12" x 12" x 15" depth (305 mm x 305 mm x 380 mm)
- Corrugated aluminum layers, combined with advanced polymer membrane, UL94 HF-1
- Transfers both sensible & latent heat.
- Endure harsh temperatures; effective in warm and cold climates
- Water washable
- Meets ASHRAE 90.1

DEFROST

- Advanced supply fan shut down defrost sequence
- Defrost type: Evacuation
Activated automatically at -5°C (23°F)

DUCT CONNECTIONS

- (4) 8" x 20" (203 mm x 508 mm)

MOUNTING

- Saddle installation
- Suspended installation with threaded rod (not included)

FILTERS (MERV3)

- The FRESH/EXHAUST air streams are protected by MERV3 washable filters constructed to meet UL 900.

WARRANTY

- 2 year limited warranty on motors
- 2 year limited warranty on parts
- 3 year limited warranty on Heat Recovery Core

AIRFLOW

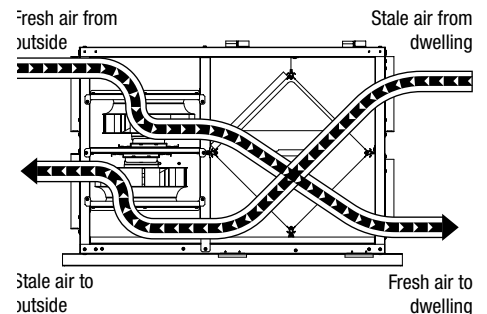

Greentek
50 Kanalfakt Way,
Boucstouche, NB Canada E4S 3M5
Toll free: 1 888 724-5211
Fax: 1 (866) 426-7430

Visit us at: www.greentek.ca

444896 / May 2022



Greentek reserves the right to modify a product, without prior notice, whether in design, colour or specifications, in order to offer at all times a quality product that is highly competitive. Please consult your national and local building codes to find out whether the installation of electrical products requires the services of a certified technician or electrician. Greentek™ is a registered Trademark used under license by Systemair Inc. All rights reserved.

ENGINEERING DATA LCH-12E

SPECIFICATIONS LCH-12E

Dimensions	51.6" x 36.2" x 22" (1310mm x 920mm x 559mm)
Duct Connections	Four (4) 8" x 20" (203mm x 508mm)
Airflow Rates	1200 CFM (566 L/s)
Motor	Four (4) factory balanced fans with backward curved blades
Voltage	120 VAC @ 60 Hz / 1 Phase
Amperage	11.17A / 1340 Watts
Type of Heat Exchanger	(3) Cross-flow (Enthalpic Polymer Membrane)
Exchange Surface	>513 in ² (0.33m ²)
Standard Defrost Type	Evacuation
Filters	Six (6) MERV3 washable filters
Drain Connection	Two (2) 1/2" (12.7mm)
Actual Weight	232 lbs (105 Kg)
Shipping Weight	280 lbs (127Kg)
Shipping Dimensions	38" x 53" x 27" (965mm x 1346mm x 686mm)
Certification	cCSA US, CSA 22.2 N ^o .113 Complies with UL 1812

OPTIONAL WALL CONTROLS

Vectra Series	EHC 1.5 and EHC 1.0
RD Series	RD-1, RD-2, RD-3P, RD-4P
Timers	T3 (20, 40, 60 minutes)

WALL CONTROL DIMENSIONS

Vectra Series

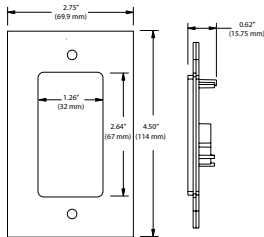

RD Series

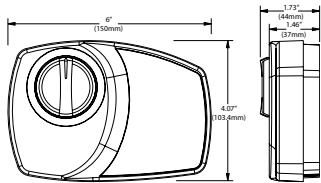

T3 Timer

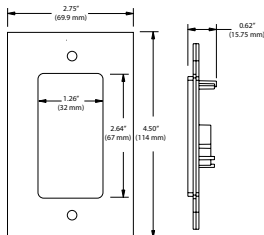

DIMENSIONS DATA

Side View

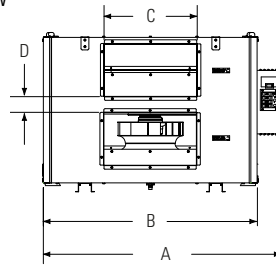

Front View

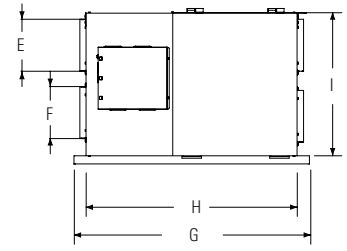

A	B	C	D	E	F	G	H	I
in (mm)	in (mm)	in (mm)	in (mm)	in (mm)	in (mm)	in (mm)	in (mm)	in (mm)
51.6 (1310)	47.3 (1202)	20 (508)	2.5 (63)	8 (203)	8 (203)	36.2 (920)	32.5 (826)	22 (559)

VENTILATION PERFORMANCE

in. wg. (Pa)	0.2 (50)	0.4 (100)	0.6 (150)	0.8 (200)	1.0 (250)	1.2 (400)	1.8 (450)
	cfm (L/s)	cfm (L/s)	cfm (L/s)	cfm (L/s)	cfm (L/s)	cfm (L/s)	cfm (L/s)
Supply High	1230 (580)	1179 (556)	1121 (529)	1057 (499)	985 (465)	906 (482)	629 (297)
Supply Med	904 (427)	817 (386)	729 (344)	639 (302)	548 (259)	455 (215)	167 (79)
Supply Low	650 (307)	544 (257)	439 (207)	333 (157)	227 (107)	121 (57)	-

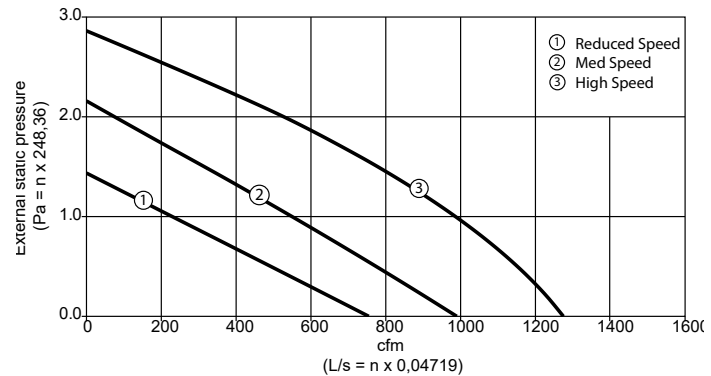

ENERGY PERFORMANCE CORE*

	Net Air Flow		Net Effectiveness		Net Effectiveness
	L/s	CFM	Sensible	Latent	Total
HEATING	396	840	54	35	50
	297	630	57	40	54
COOLING	396	840	51	32	49
	297	630	60	37	53

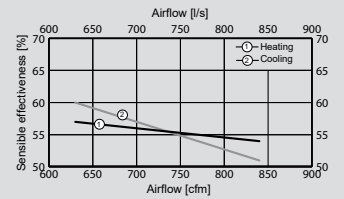

*Actual performance may vary pending conditions

Quoted by:	Date:
Project:	Remarks:
Quantity:	
Model:	
Site:	
Architect:	
Engineer:	
Contractor:	