

# ENGINEERING DATA

## LCH-4E

### Energy Recovery Ventilator

200 CFM (94 L/s) to 450 CFM (212 L/s)

Item No. 463303



#### FEATURES

- Push-pull configuration
- 100% Variable speed
- 3 Operating modes (Intermittent; Continuous; High)
- Advanced electronic balancing
- Dual service doors & reversible electrical box

#### APPLICABLE REQUIREMENTS

- Technical data was obtained from published results of test relating to AHRI 1060 Standards
- CSA Standard CSA 22.2 N<sup>o</sup>.113-10 - Fans and ventilators
- UL Standard 1812 2<sup>nd</sup> Ed. Ducted heat/energy recovery ventilators (HRV/ERV)

#### OPTIONS

- 463308 GTPDK14 O/A motorized prevention damper kit



GTPDK14

#### CABINET

- 22 gauge galvanized pre-painted steel corrosion resistant

#### ELECTRONIC COMPONENTS

- Electrical Input Voltage: 120 VAC/60Hz / 1-Phase
- Electrical Input Current: 4.17 Amps Max
- Integrated auxiliary furnace interlock relay
- Intergrated 24V connection (18VA)
- RoHs compliant

#### MOTORS

- Two (2) factory balanced fans with backward curved blades.
- Motors come with permanently lubricated sealed ball bearings, maintenance free
- IP protection class 44 according to DIN 40 050
- 115V, 60Hz, 2.1 Amps
- Maximum RPM 2750 / Horsepower; 0.42 HP

#### POLYMER MEMBRANE ERV CORE

- Dimensions (2) 11.4" x 11.4" x 11.4" depth (290 mm x 290 mm x 290 mm)
- Corrugated aluminum layers, combined with advanced polymer membrane, UL94 HF-1
- Transfers both sensible & latent heat.
- Endure harsh temperatures; effective in warm and cold climates
- Water washable
- Meets ASHRAE 90.1

#### ELECTRONIC BALANCING SYSTEM (DUOTROL)

- The system is balanced by adjusting each motor independently
- No balancing dampers required
- Connection terminals for optional wall controls
- Quiet and energy efficient

#### DEFROST

- Advanced supply fan shut down defrost sequence
- Defrost type: Evacuation  
Activated automatically at -5°C (23°F)

#### DUCT CONNECTIONS

- (4) 8" x 14" (203 mm x 355 mm)

#### MOUNTING

- Saddle installation
- Suspended installation with threaded rod (not included)

#### FILTERS (MERV6)

- The FRESH/EXHAUST air streams are protected by MERV6 washable filters constructed to meet UL 900.

#### WARRANTY

- 2 year limited warranty on motors
- 2 year limited warranty on parts
- 3 year limited warranty on Energy Recovery Core

#### AIRFLOW

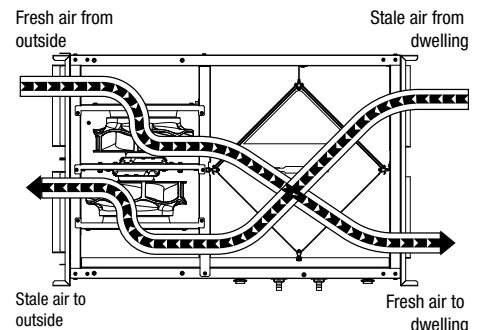

Greentek  
50 Kanalfakt Way,  
Boucoucher, NB Canada E4S 3M5

Toll free: 1 888 724-5211  
Fax: 1 (866) 426-7430

Visit us at: [www.greentek.ca](http://www.greentek.ca)

444892 / March 2022



Greentek reserves the right to modify a product, without prior notice, whether in design, colour or specifications, in order to offer at all times a quality product that is highly competitive. Please consult your national and local building codes to find out whether the installation of electrical products requires the services of a certified technician or electrician. Greentek™ is a registered Trademark used under license by Systemair Inc. All rights reserved.

# ENGINEERING DATA LCH-4E

## SPECIFICATIONS LCH-4E

<b>Dimensions</b>	29.4" x 35.9" x 22.7" (747 mm x 911 mm x 577 mm)
<b>Duct Connections</b>	Four (4) 8" x 14" (203mm x 355mm)
<b>Airflow Rates</b>	200 CFM (94 L/s) to 450 CFM (212 L/s)
<b>Motor</b>	Two (2) factory balanced fans with backward curved blades
<b>Voltage</b>	120 VAC @ 60 Hz / 1 Phase
<b>Amperage</b>	4.17A / 500 Watts
<b>Type of Heat Exchanger</b>	Two (2) Cross-flow (Enthalpic Polymer Membrane)
<b>Exchange Surface</b>	>260 in <sup>2</sup> (0.17m <sup>2</sup> )
<b>Standard Defrost Type</b>	Evacuation
<b>Filters</b>	Four (4) MERV 6 washable filters
<b>Drain Connection</b>	Two (2) 1/2" (12.7 mm)
<b>Actual Weight</b>	132 lbs (60 Kg)
<b>Shipping Weight</b>	167 lbs (76 Kg)
<b>Shipping Dimensions</b>	38" x 38" x 27" (965mm x 965mm x 686mm)
<b>Certification</b>	cCSAUS, CSA 22.2 N <sup>o</sup> .113 Complies with UL 1812

## OPTIONAL WALL CONTROLS

<b>Vectra Series</b>	EHC 1.5 and EHC 1.0
<b>RD Series</b>	RD-1, RD-2, RD-3P, RD-4P
<b>Timers</b>	T3 (20, 40, 60 minutes)

### Vectra Series

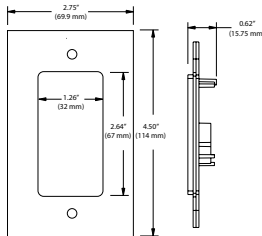

### RD Series

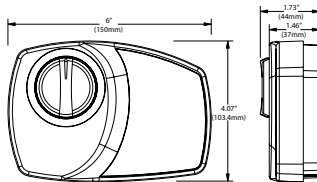

### T3 Timer

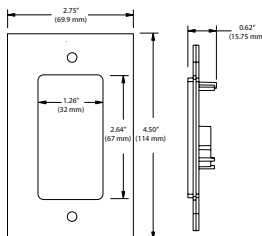

## DIMENSIONS DATA

Side View

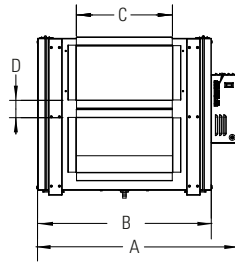

Front View

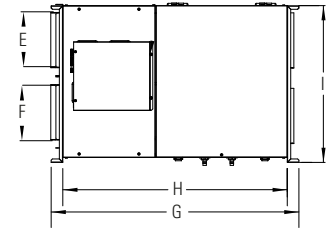

A	B	C	D	E	F	G	H	I
in (mm)	in (mm)	in (mm)	in (mm)	in (mm)	in (mm)	in (mm)	in (mm)	in (mm)
29.4 (747)	25.2 (639)	14 (355)	2.5 (63)	8 (203)	8 (203)	35.9 (911)	32.5 (826)	22.7 (577)

## VENTILATION PERFORMANCE

in. wg. (Pa)	0.2 (50)	0.4 (100)	0.6 (150)	0.8 (200)	1.0 (250)	1.2 (300)	1.4 (350)	1.6 (400)
	cfm (L/s)	cfm (L/s)	cfm (L/s)	cfm (L/s)	cfm (L/s)	cfm (L/s)	cfm (L/s)	cfm (L/s)
Supply High	509 (240)	468 (221)	425 (201)	381 (180)	334 (158)	285 (135)	235 (111)	182 (86)
Supply Med	410 (193)	361 (170)	309 (146)	254 (120)	196 (93)	135 (64)	70 (33)	-
Supply Low	277 (131)	222 (105)	158 (75)	85 (40)	-	-	-	-

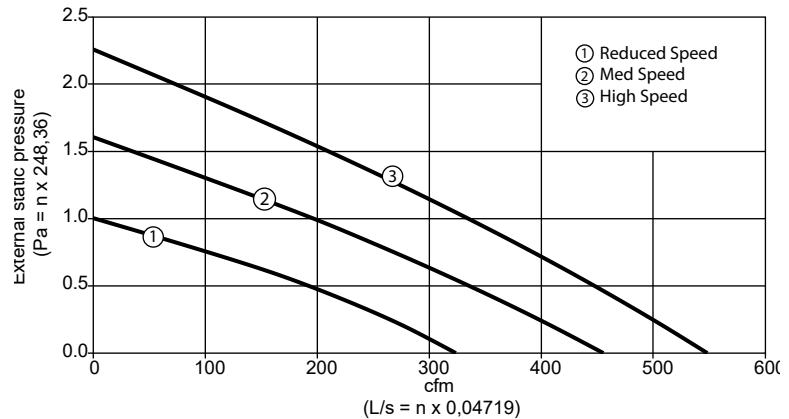

## ENERGY PERFORMANCE CORE\*

	Net Air Flow		Net Effectiveness		Net Effectiveness	Net Effectiveness
	L/s	CFM	Sensible	Latent		
<b>HEATING</b>	142	300	63	46	6	93
	106	225	66	51		
<b>COOLING</b>	142	300	63	42	5	106
	106	225	66	48		

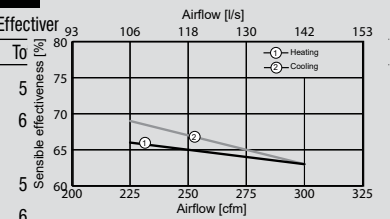

\*Actual performance may vary pending conditions

Quoted by:	Date:
Project:	Remarks:
Quantity:	
Model:	
Site:	
Architect:	
Engineer:	
Contractor:	